

WIDE GEAR

the perfect solution to fat tire fitment!

FITS '91-UP FIVE SPEEDS
NEW!

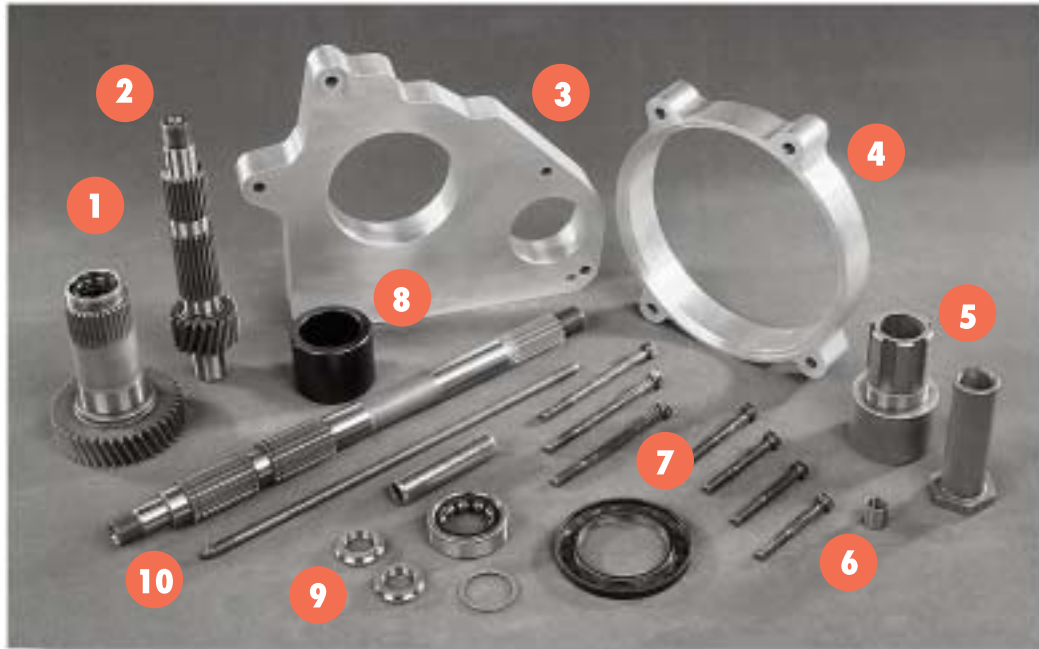

1. output shaft
2. countershaft
3. transmission spacer
4. engine spacer
5. engine sprocket extension compensator nut
6. support bearing
7. triple lip oil seal
8. chamfered spacer
9. four-point bearing (2)
10. mainshaft clutch pushrod

WIDEGEAR

NEW!

The Engineered Solution For Fat Tire Cruisers!

This is it! The engineered solution for fitting today's mega-width tires to late model ('91-up) five-speeds comes complete with all parts necessary for in-frame installation, including JE's exclusive triple lip oil seal, 4-point trapdoor bearings, and chamfered, extra-hard transmission spacer.

Incorporating the smoother, quieter, stronger, and quicker TwistGear™ helical fifth-gear close ratio technology, correct tire clearance is provided by extending both the transmission and engine sprocket shafts instead of playing around with wheel or drivetrain offsets. WideGear also incorporates an engine shaft end bearing (requires suitable outer primary) for additional support.

A complete tech bulletin (WideGear tech.PDF) is available on the web.

System price: \$1,295.00 (FL/FXR \$1,395.00)

Johnson Engineering 100 Blake Road Denver, IA 50622
(319)984-9298/(319)984-9299 fax www.twistgear.net/info@twistgear.net